

Cisco

Exam Questions 100-890

Supporting Cisco Collaboration Devices



NEW QUESTION 1

How can the IP address of the Cisco Webex Room 70D system be found?

- A. On the Touch 10 controller screen tap System Name In the upper-left corner and tap Configurations followed by Network
- B. On the Touch 10 controller screen, tap System Name in the upper-left corner and tap Settings followed by About this device.
- C. On the Touch 10 controller screen, tap Setup in the upper-left corner and tap Settings followed by About this device
- D. On the Touch 10 controller screen tap Setup in the upper-left corner and tap Configurations followed by Network

Answer: B

NEW QUESTION 2

Which Collaboration Room system requires another device to make audio or video calls?

- A. Cisco Webex Room Kit Mini
- B. Cisco Webex Room Kit Pro
- C. Cisco Webex Room USB
- D. Cisco Webex Room Kit
- E. Cisco Webex Room Kit Plus

Answer: C

Explanation:

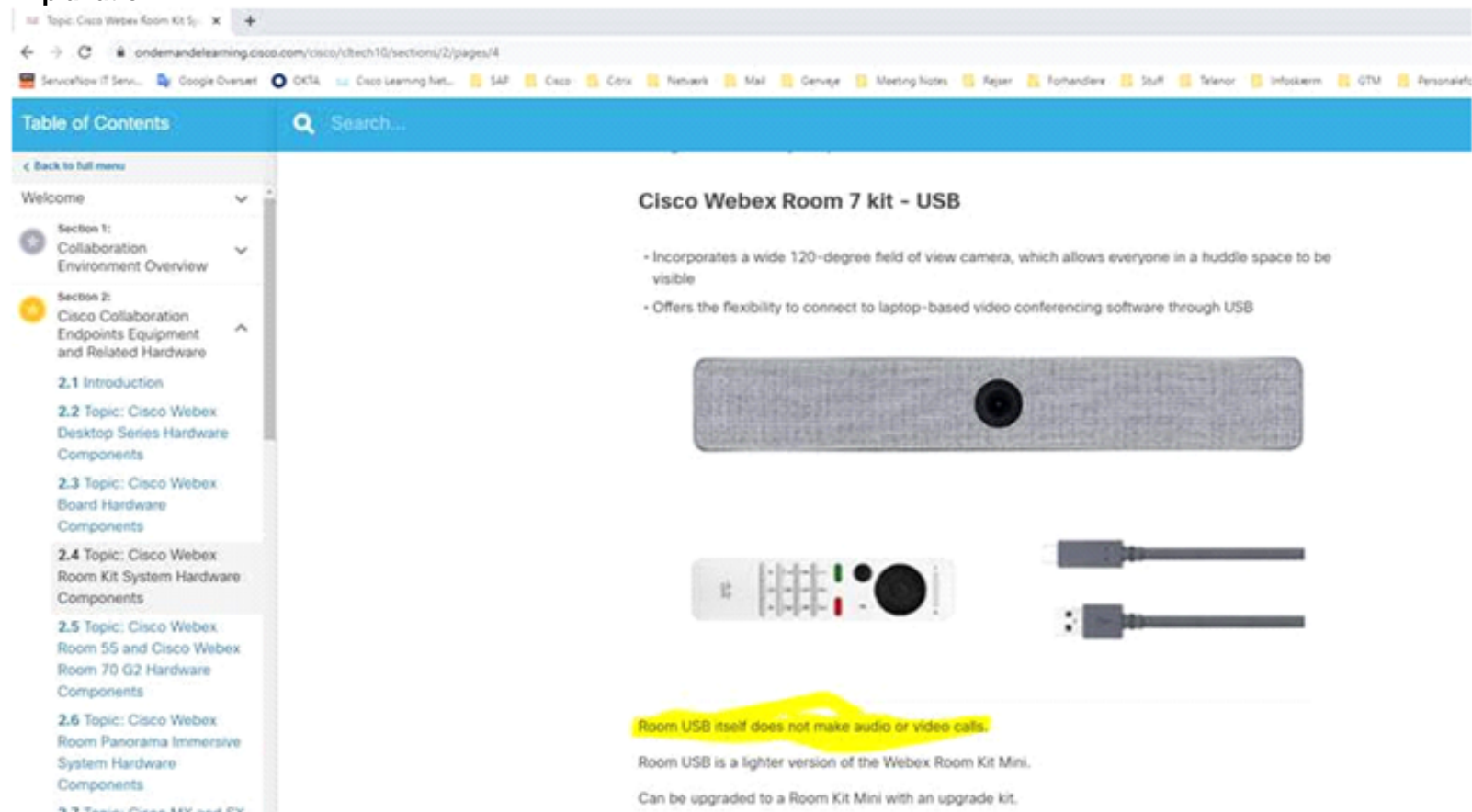

NEW QUESTION 3

Which three statements describe the Cisco TelePresence Management Suite (TMS)? (Choose three.)

- A. TMS is aware of the call signaling between the call control device and the endpoints
- B. TMS can integrate with Microsoft Exchange and Outlook to support flexible meeting scheduling
- C. The complexity of a TMS installation is determined by the number of Cisco Unified Communication Manager platforms in a Cisco Unified CM deployment
- D. TMS provides distributed control for on-site and remote video systems
- E. TMS provides centralized control for on-site and remote video systems
- F. TMS is a portal for managing and monitoring a video conferencing network

Answer: BEF

NEW QUESTION 4

How many microphone locations does Cisco Webex Desk Pro support?

- A. 2
- B. 4
- C. 6
- D. 8

Answer: C

NEW QUESTION 5

The Certificate Trust List (CTL) file is an important file that the Cisco IP phone downloads during the bootup process. What information is defined in the CTL file?

- A. CTL contains a list of certificates and feature licenses that the IP phone is authorized to use
- B. CTL specifies a list of configuration files that the phone can download from the TFTP server

- C. CTL contains a list of Cisco Unified CM and TFTP servers that the IP phone is authorized to connect to.
- D. CTL defines how the Cisco IP Phone communicates with Cisco Unified CM and provides a phone with its load ID

Answer: C

NEW QUESTION 6

What is based on the Bootstrap Protocol (BOOTP) and provides the framework for passing configuration information to hosts on a TCP/IP network?

- A. Domain Name System (DNS)
- B. Dynamic Host Configuration Protocol (DHCP)
- C. Cisco Discovery Protocol
- D. Network Time Protocol (NTP)

Answer: B

Explanation:

<https://www.cisco.com/c/en/us/td/docs/routers/asr920/configuration/guide/ipaddr-dhcp/16-12-1/b-dhcp-xe-16-12>

The Dynamic Host Configuration Protocol (DHCP) is based on the Bootstrap Protocol (BOOTP), which provides the framework for passing configuration information to hosts on a TCP/IP network. DHCP adds the capability to automatically allocate reusable network addresses and configuration options to Internet hosts.

NEW QUESTION 7

Which network administration command-line tool is available in many computer operating systems for querying the Domain Name System (DNS)?

- A. nslookup
- B. ping
- C. netstat -a
- D. traceroute

Answer: A

NEW QUESTION 8

Drag and drop the sizes from the left onto the availability for Webex Board on the right Not all sizes are used

24-inch	available size for Webex Board
55-inch	available size for Webex Board
70-inch	available size for Webex Board
85-inch	

- A. Mastered
- B. Not Mastered

Answer: A

Explanation:

Table Description automatically generated

<https://www.webex.com/video-conference-equipment/webex-boards.html>

NEW QUESTION 9

Refer to the exhibit.

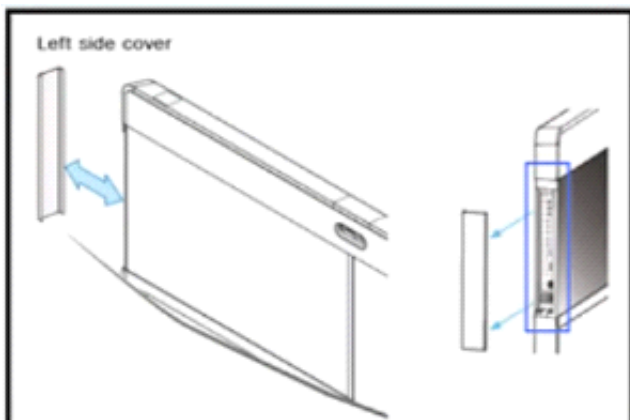

Which component can be found in the Cisco Webex Room 70D system left screen? Host CPU Screen control unit POU Codec?

- A. Host CPU
- B. Screen control unit
- C. PDU

D. Codec

Answer: C

NEW QUESTION 10

What are two benefits of using the Cisco Ceiling Microphone?(Choose two)

- A. Smartphone connectivity
- B. portable
- C. directional
- D. frees up table space
- E. higher volume

Answer: CD

Explanation:

<https://www.cisco.com/c/en/us/products/collateral/collaboration-endpoints/telepresence-microphones/datasheet>

NEW QUESTION 10

Which two devices can provide a Cisco IP phone the network connection and power necessary for the phone to function in the IP telephony network? (Choose two)

- A. IP phone power adapter with Ethernet port
- B. Cisco Unified Communications Manager PoE port
- C. Cisco TelePresence codec
- D. Cisco Voice Gateway PoE port
- E. Cisco Catalyst PoE switch

Answer: DE

NEW QUESTION 15

Which device controls the Webex Room Panorama 70?

- A. Cisco Touch 10 control unit
- B. Cisco remote control
- C. Smartphone
- D. computer

Answer: A

NEW QUESTION 17

What is the purpose of Intelligent Proximity?

- A. Speaker tracking
- B. Camera control
- C. Presenter tracking
- D. Content sharing

Answer: D

Explanation:

<https://www.cisco.com/c/dam/en/us/td/docs/telepresence/endpoint/ce92/touch10-sx10-sx20-sx80-mx200g2-mx3>

NEW QUESTION 18

Which two components will Cisco Webex Room 55 Dual support? (Choose two.)

- A. two microphone input devices and three video output devices
- B. Wheel Mount configuration
- C. three microphone input devices and two video output devices
- D. one 55-in display 4K LED screen
- E. 4x lenses speaker track

Answer: CD

Explanation:

<https://www.cisco.com/c/en/us/products/collateral/collaboration-endpoints/webex-room-series/datasheet-c78-74>

NEW QUESTION 21

How can Quality of Service be described?

- A. Speed is the maximum amount of Information in bits per second that can be transmitted across a network
- B. Relay is the finite amount of time that it takes a packet to reach the receiving endpoint after being transmitted from the sending endpoint
- C. Packet loss is a relative measure of the number of packets that were not received compared to the total number of packets transmitted
- D. Latency is the difference in the end-to-end delay between packets

Answer: D

NEW QUESTION 26

What does the status LED around the power button on the DX80 mean when it repeatedly flashes twice?

- A. standby mode
- B. incoming call
- C. no network connection
- D. normal operation

Answer: C

Explanation:

<https://www.cisco.com/c/dam/en/us/td/docs/telepresence/endpoint/ce90/dx70-dx80-administrator-guide-ce90.pdf>

NEW QUESTION 30

What are two reasons that video conferencing solutions developed before the 1990s were impractical? (Choose two)

- A. They operated at a high expense.
- B. They produced an unreliable image quality
- C. They produced high-resolution image quality
- D. They had not been invented yet.
- E. They operated at a high frame rate

Answer: AB

NEW QUESTION 34

How many 1080-p. 30-fps content-sharing streams does Cisco IX5000 support?

- A. 2
- B. 3
- C. 4
- D. 5

Answer: A

NEW QUESTION 38

Which type of network can transmit data voice and video or any combination of these services over the same networks?

- A. traditional network
- B. dedicated network
- C. multimode network
- D. converged network

Answer: D

NEW QUESTION 39

What are two standard fiber-optic connectors? (Choose two.)

- A. Lucent
- B. rollover
- C. subscriber
- D. multidimension
- E. crossover

Answer: AC

NEW QUESTION 43

What can cause a MAC address mismatch when an endpoint fails to register to Cisco Unified CM?

- A. DNS server is not available
- B. MAC address is entered incorrectly
- C. Gateway address is missing
- D. Endpoint is unplugged

Answer: A

NEW QUESTION 45

Which command shows the status of power supplies and sensor temperatures?

- A. show hardware
- B. show module
- C. show environment
- D. show diag

Answer: C

NEW QUESTION 49

What provides the coding and decoding translation between analog and digital facilities?

- A. Transformer
- B. Translator
- C. Converter
- D. Codec

Answer: D

NEW QUESTION 52

From the Diagnostics page, which two alerts are clearly marked red? (Choose two)

- A. Out of service
- B. Errors
- C. Blockage
- D. Critical
- E. Warning

Answer: AB

NEW QUESTION 57

Which misled Certificate Authorities {CAs} are necessary to validate the certificates of external servers (HTTPS and syslog)?

- A. Custom
- B. Custom and Collaboration Edge
- C. Collaboration Edge
- D. Preinstalled

Answer: C

NEW QUESTION 58

Which two statements describe Cisco Meeting Server 1000 and 2000? (Choose two.)

- A. Cisco Meeting Server 1000 and 2000 are preconfigured as virtualized servers
- B. Both servers support the H 323 protocol
- C. Cisco Meeting Server is an on-premises conferencing platform
- D. Both servers support the SIP protocol
- E. Cisco Meeting Server 1000 runs on a preconfigured UCS 5108 blade server

Answer: AE

NEW QUESTION 59

Which feature can be turned on from the Touch 10 controller to check the camera s Pan Till Zoom, maximized, and minimized views m order to verify that the Cisco TelePresence MX800 Dual System camera movement operates correctly?

- A. Selfview
- B. CameraPreset
- C. CameraControl
- D. Remoteview

Answer: A

NEW QUESTION 63

.....

Thank You for Trying Our Product

We offer two products:

1st - We have Practice Tests Software with Actual Exam Questions

2nd - Questions and Answers in PDF Format

100-890 Practice Exam Features:

- * 100-890 Questions and Answers Updated Frequently
- * 100-890 Practice Questions Verified by Expert Senior Certified Staff
- * 100-890 Most Realistic Questions that Guarantee you a Pass on Your First Try
- * 100-890 Practice Test Questions in Multiple Choice Formats and Updates for 1 Year

100% Actual & Verified — Instant Download, Please Click
[Order The 100-890 Practice Test Here](#)